



## **HYMER** **Access Technology**

**Personal.  
Intelligent.  
Reliable.**

**Customised  
working platforms  
for motorhomes, caravans,  
vans and special vehicles.**



“

**HYMER is your professional project and development partner when you require customised access solutions.**

**We are a business unit of the independent access technology specialist Hymer-Leichtmetallbau.**

**Our mandate is to place our many years of experience at your disposal and supply you with reliable solutions, from the first idea and its intelligent realisation through to a comprehensive after sales service.**

**We place a high priority on personal contact and intensive dialogue with our customers. Find out about our professional competence.**

Christian Frei, Head of Sales Access Technology

”

## Contents

Platforms for roof work .....	4
Platforms for work on vehicle front and rear .....	6
Platforms for work on vehicle sides .....	8
Platforms for work on several sides .....	10
Supplementary solutions .....	12
Professional inspection of your operational special constructions .....	14
Your contacts .....	16



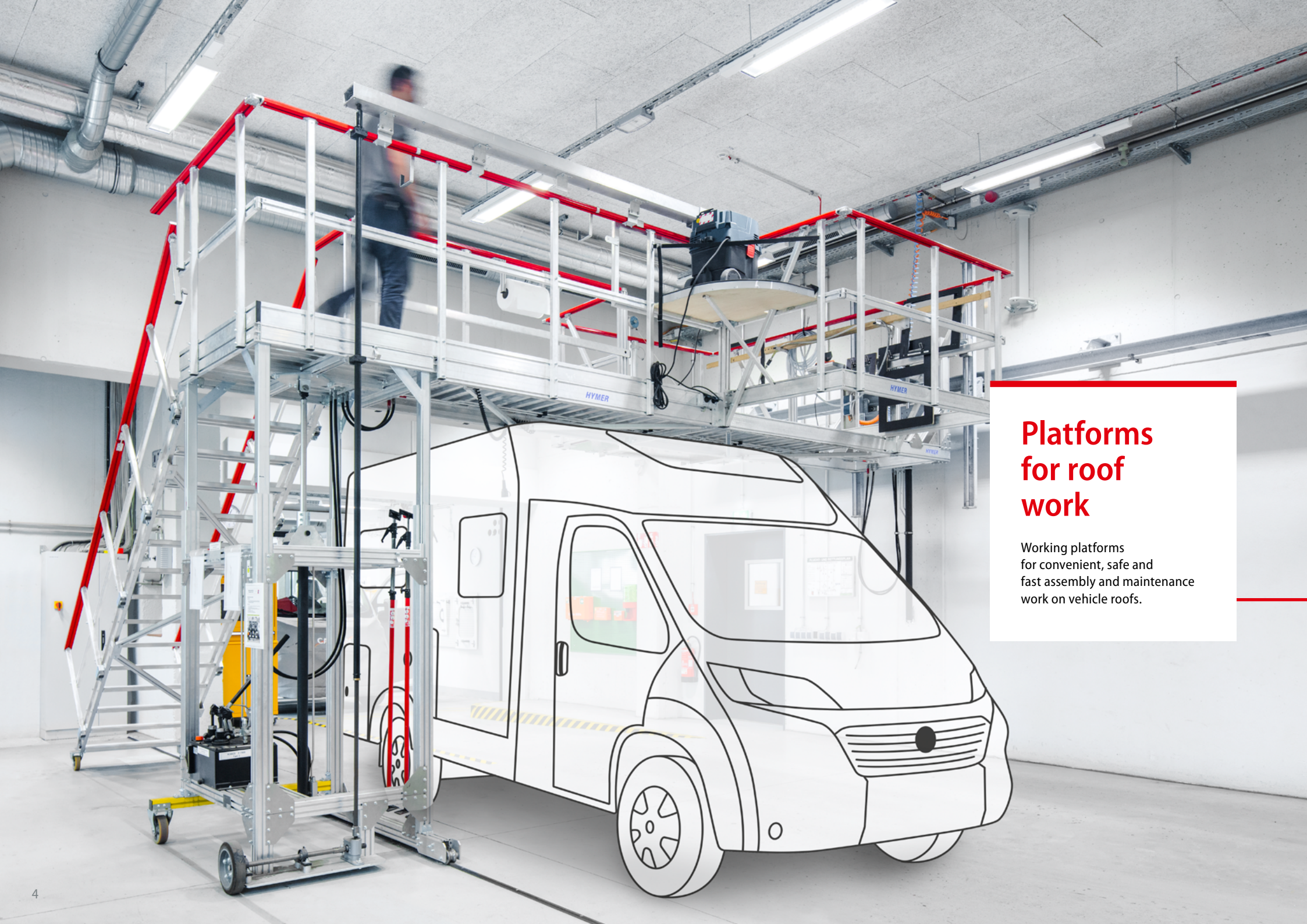

## Platforms for roof work

Working platforms  
for convenient, safe and  
fast assembly and maintenance  
work on vehicle roofs.



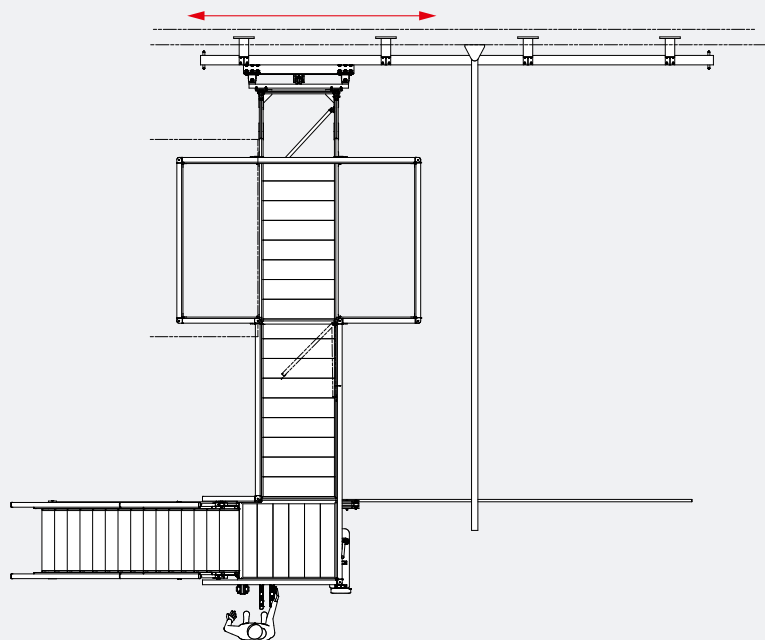

## Other sample projects:



Mobile platform steps for safe, time-saving work on vehicle or ventilation hoods, assembly of satellite dishes and many other workings on the roof.

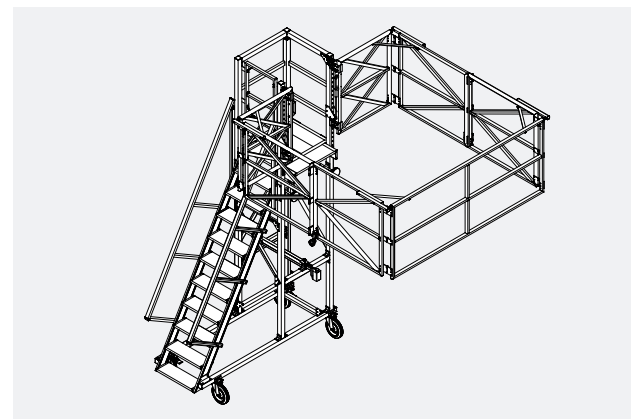
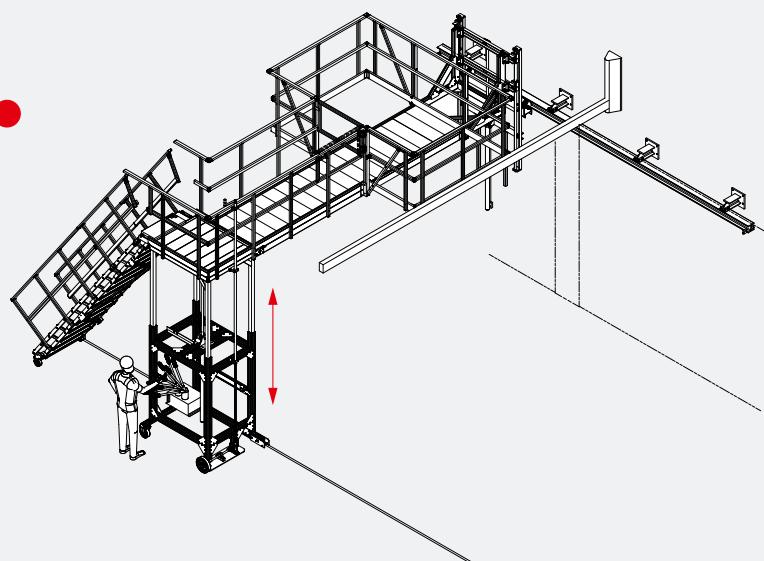

Mobile platform steps with folding safety guardrail for assembly and maintenance work to or on the roof.

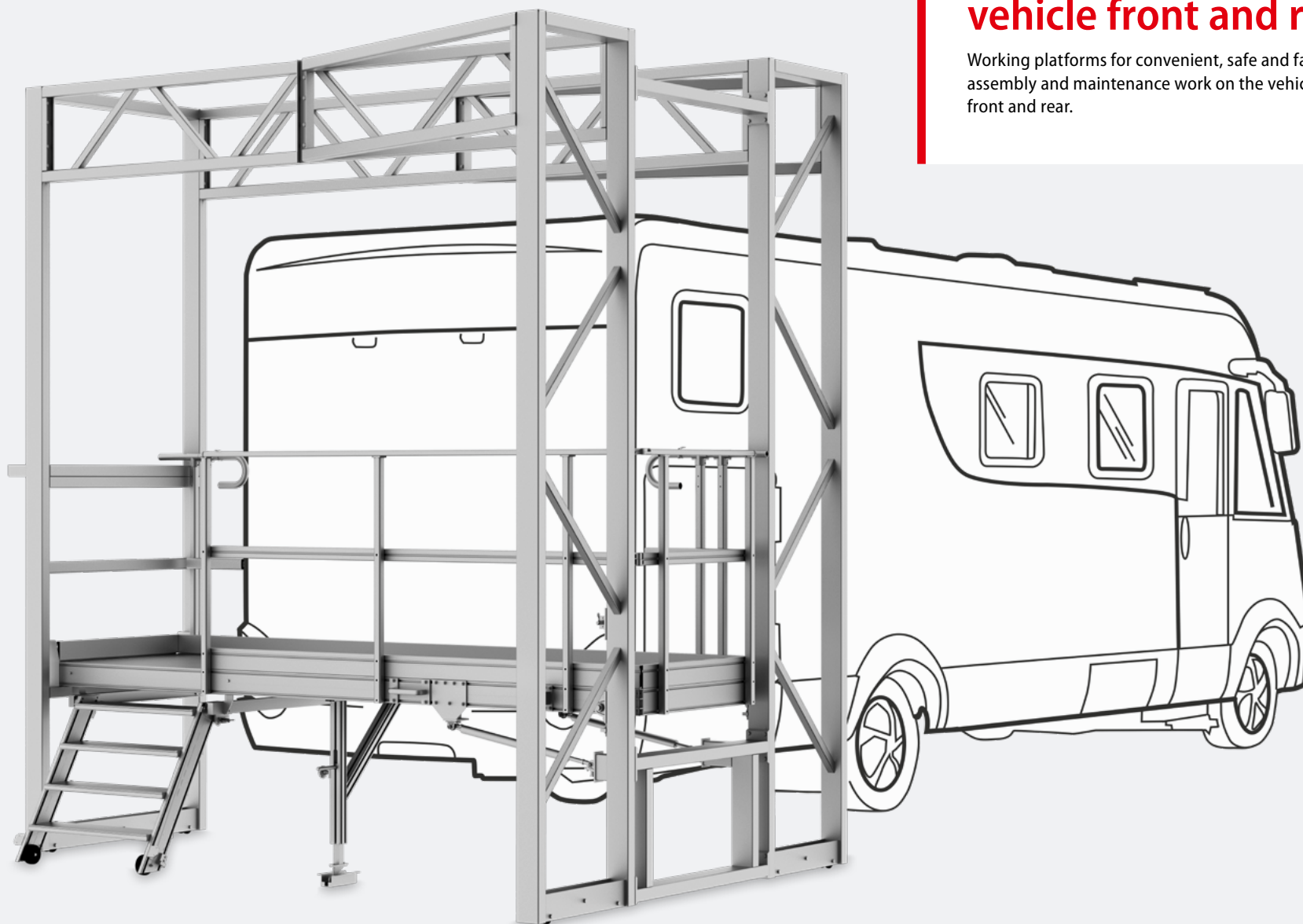

## Platforms for work on vehicle front and rear

Working platforms for convenient, safe and fast assembly and maintenance work on the vehicle front and rear.



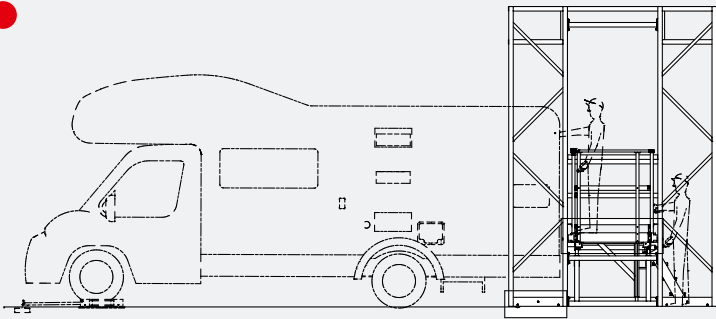

## Other sample projects:



Mobile platform for work on areas of the vehicle that are difficult to access such as the front.

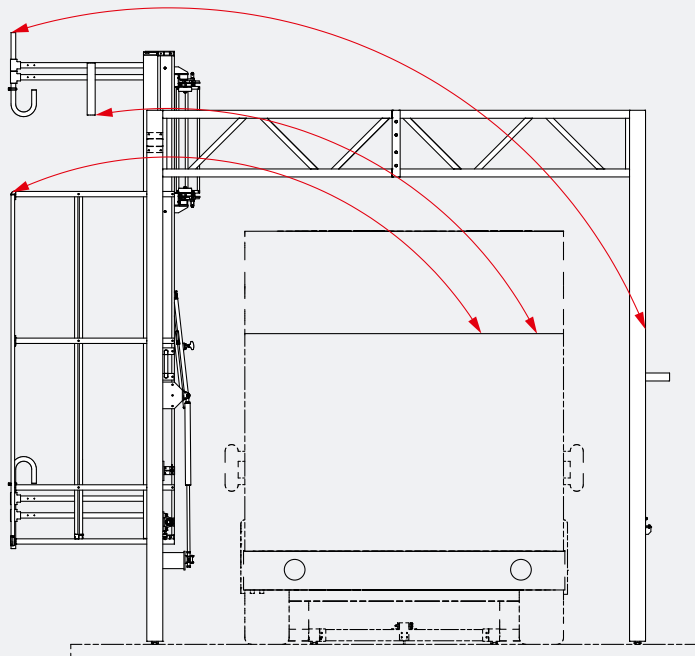





## Platforms for work on vehicle sides

Working platforms for convenient, safe and fast assembly and maintenance work on vehicle sides.



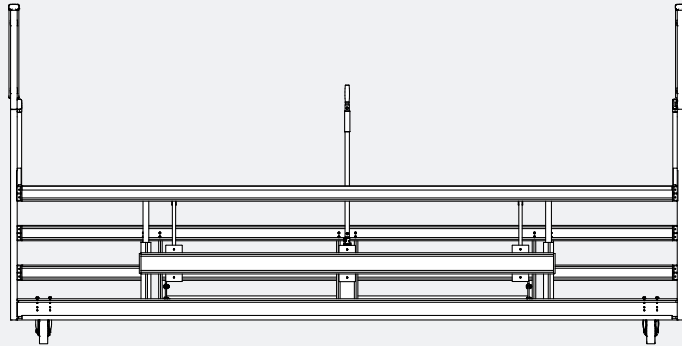

## Other sample projects:



Height-adjustable mobile working platform for the assembly of side and rear panels.

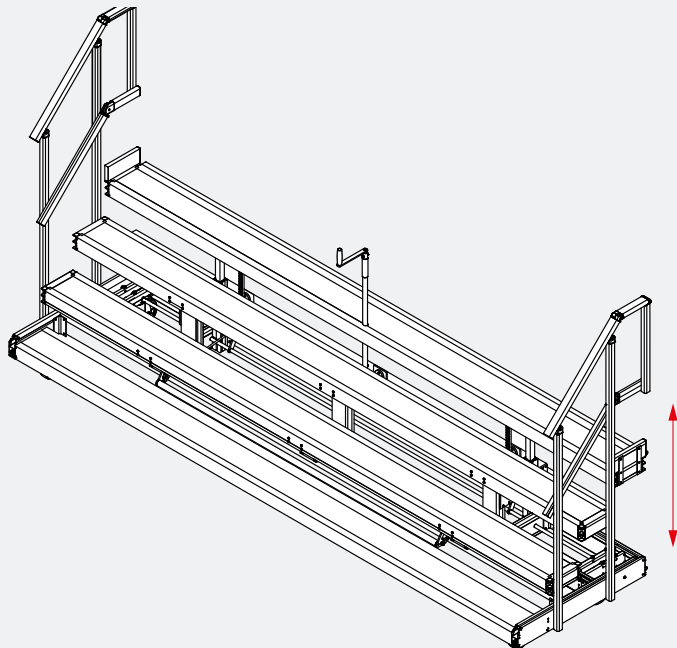

Height-adjustable mobile working platform for repairs, maintenance and assembly work on side panels.





## Platforms for work on several sides

Working platforms for convenient, safe and fast assembly and maintenance work which is carried out on several sides of the vehicle at the same time.



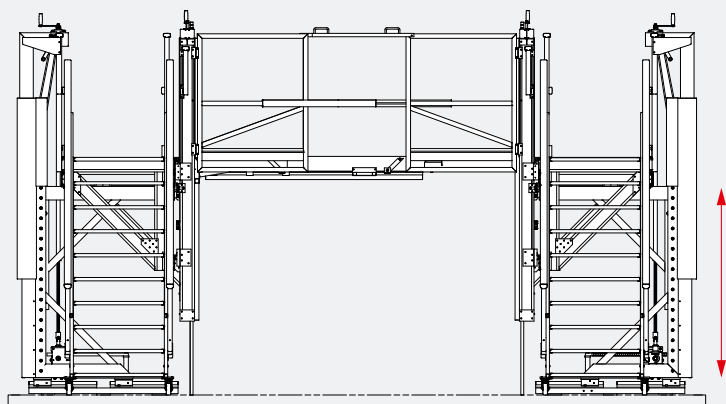

## Other sample projects:

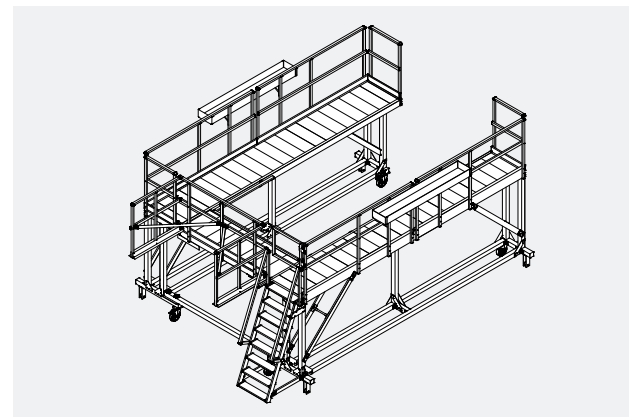

Fixed height working platform with mobile middle section that adapts to different vehicle lengths.

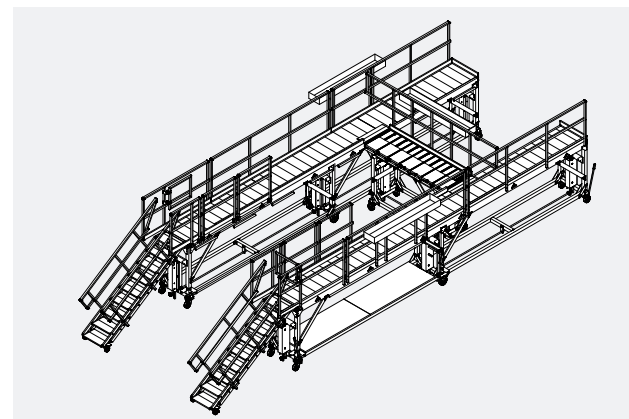

Height-adjustable working platform with mobile middle section that adapts to different vehicle lengths.

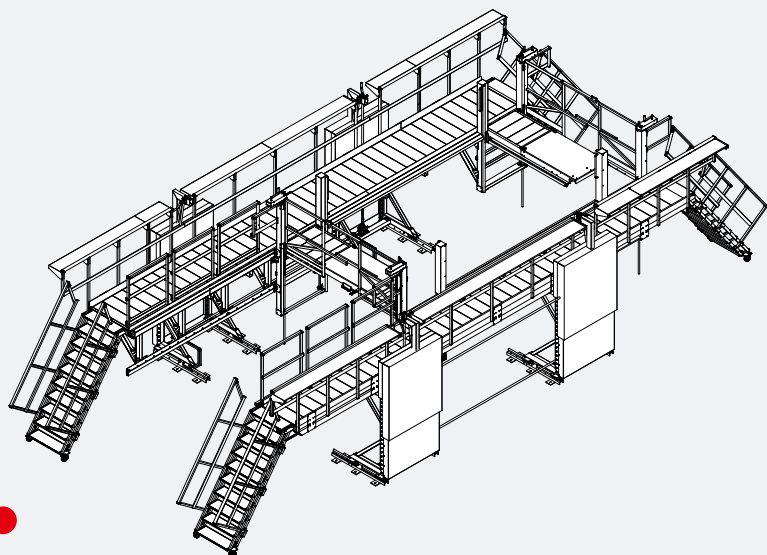



## Supplementary solutions

Versatile transport and access solutions made of aluminium.  
Safe. Efficient. Reliable.



## Sample projects:

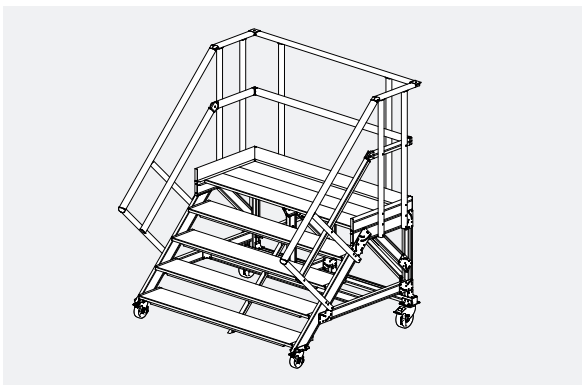

Mobile working platform with an extended standing area.



Mobile working platform with double-sided access.

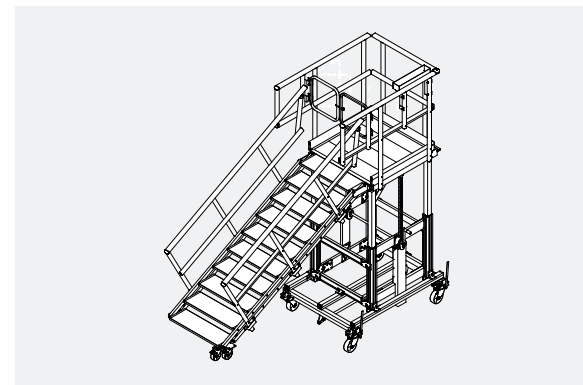

Height-adjustable compact working platform for versatile, flexible assembly and maintenance work on vehicles.

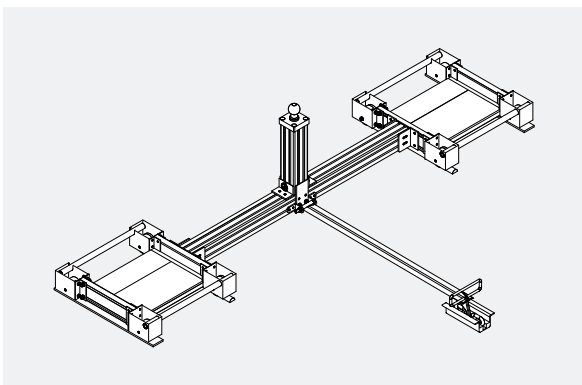

Tow-bar carriage to move vehicles on production lines (left).

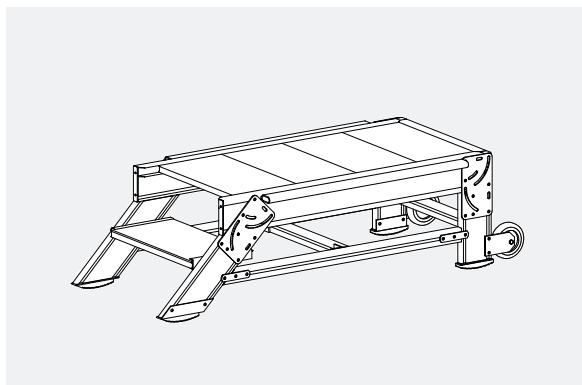

Mobile aluminium step with extended standing area to carry out convenient, safe assembly work.

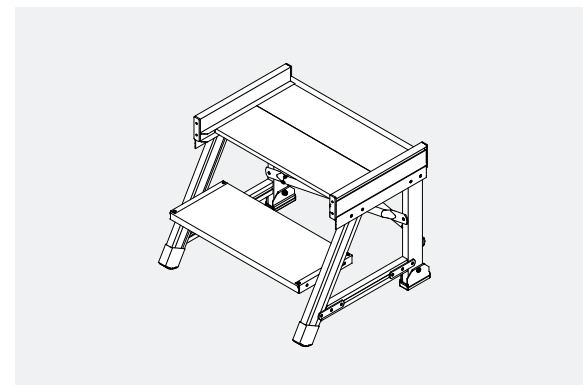

Flexible step for short-term work operations such as mounting side mirrors.





## Professional inspection of your operational special constructions

In compliance with German Ordinance on Industrial Safety  
and Health (BetrSichV) and TRBS 1201.





“

The advantage when it comes to inspecting your special access technology constructions by our experts? Our long-term experience and expertise.

If defects requiring repair are detected during the inspection, we have the necessary expertise and equipment with us to rectify them.

Martin Rost, Production Access Technology

”

## Why do special access technology constructions require regular inspection?

Stairs, platforms, walkways, crossings and other access systems mainly contribute to the smooth flow of logistics operations inside a company. However, they conceal other risks, in particular when work equipment shows signs of damage or defects. The possible consequence may be accidents and follow-on costs for your company.

The German Workplace Ordinance (ArbStättV) and the German Ordinance on Industrial Safety and Health (BetrSichV) therefore specify explicitly that company access systems must be inspected for proper condition by an authorised person at regular intervals.

## Who conducts the inspection?

Our company experts are trained by the German DEKRA (auditing and certification services) and conduct inspections at your company locations (prices on request; vertical ladders excepted).

Whereas standard access technology such as ladders, steps and mobile towers can usually be inspected by in-house employees, more complex and customised access equipment should be inspected by specially trained experts for accident prevention reasons.

## What happens during an inspection?

Inspections are based on numerous criteria, such as deformation, damage, corrosion or wear, stability, completeness of accessories, function of drive, brake or height-adjustment mechanisms, etc.

All inspection results are documented.

As required, our experts carry out repairs directly on site. Access equipment inspected are certified by a HYMER test seal. The inspections comply with the stipulations of the German Ordinance on Industrial Safety and Health and the Technical Regulations on Industrial Safety and Health (TRBS).

## How often should company access equipment be inspected?

Company access equipment should be professionally inspected at least once a year – more frequently if it is used more intensively or more often.

**H  
Y  
M  
E  
R**

**Hymer-Leichtmetallbau GmbH & Co. KG**  
Käferhofen 10 | 88239 Wangen | GERMANY  
Tel. +49 75 22 702 | Fax +49 75 22 700-179  
[technical-sales@hymer-alu.de](mailto:technical-sales@hymer-alu.de) | [hymer-access.com](http://hymer-access.com)